

## User Manual

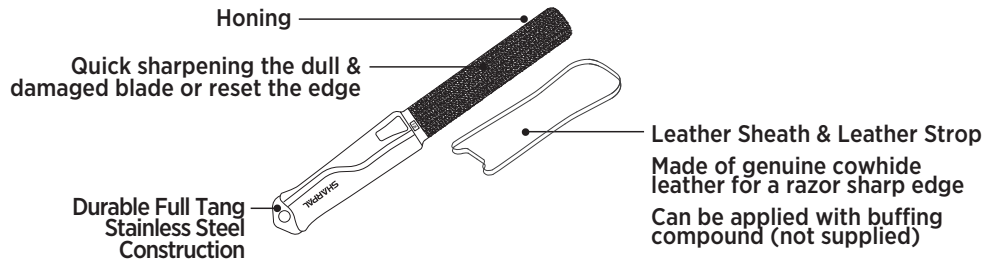

### SHARPENING INSTRUCTIONS:

1. Select the appropriate diamond side based on the condition of your blade.

**Coarse 325 grit (45 micron)** - Quick sharpening the dull & damaged blade or reset the edge on your knife blade or tool.

**Extra fine 1200 grit (12 micron)** - Honing

2. Place your blade on the heel of the diamond sharpener at the desired sharpening angle and **PUSH** the blade **AWAY** from you like you are trying to carve a thin slice off the top of the diamond surface. Push the knife blade across the sharpener as you push to sharpen the cutting edge all the way out to the tip of the blade (See Fig. 1). Repeat this **PUSHING** stroke several times. Remember to hold the angle as you push and try to maintain a consistent sharpening angle with each stroke. This is the key to obtaining the sharpest cutting edge.

3. Now sharpen the other side of the blade by placing your blade on the end of the diamond sharpener. **PULL** the blade **TOWARD** you like you are trying to carve a thin slice off the top of the diamond surface. As you pull the blade down the length of the diamond sharpener, pull the blade across the sharpener to sharpen the entire cutting edge. Let the tip come off the edge of the diamond sharpener. (See Fig. 2) Repeat this **PULLING** stroke the same number of times as you did on the opposite side of your blade and try to maintain a consistent sharpening angle with each stroke.

4. Continue sharpening both sides of your blade until you feel that your blade is truly sharp. If you started with Coarse 325 grit (45 micron) side, move to 1200 grit (12 micron) side, repeating the sharpening process. If your knife blade or tools to be sharpened merely need a touch-up or dressed edge, use only the 1200 grit (12 micron) side.

5. Thoroughly clean the diamond surface with water after use, and use a nylon scrub brush to clean the surface after some times using. This will remove metal particles that stick on the diamond surface during the sharpening process. **Always keep dry when store the diamond sharpener.**

### REALIGNING AND POLISHING INSTRUCTIONS:

The blade will have a slight burr after each use or sharpening. The leather strop is the ideal tool to realign the very fine edge of the blade and polish the blade surface.

1. One hand holds the BUDDYGUARD® with leather sheath on. Apply the compound to the rough side of leather if you would like to polish and hone the edge to a higher level. (Compound NOT supplied in this product)

2. Place the blade on the rough side of leather sheath towards the handle of sharpener at an angle of around 20°. The cutting edge should be towards the handle. With light pressure **PUSH** the blade **AWAY** from you across the surface for the length of the leather sheath- beginning at the heel of the knife and ending at the tip. (See Fig. 3)

3. When you reach the top of leather sheath, turn the blade over to strop the other side of the blade. The cutting edge should be pointed towards the top of the leather sheath and adjust the angle by raising the knife spine at around 20°. **PULL** knife blade **TOWARD** the handle across the leather to strop the entire cutting edge. (See Fig. 4)

4. Alternate both sides until the desired edge has been realized.

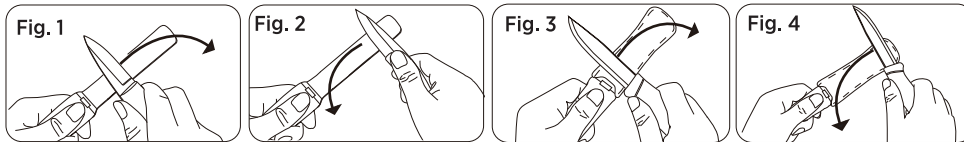

**CAUTION: Sharpening is an inherently dangerous activity. Be alert and never attempt to sharpen if you do not have full command of your mental and physical facilities.**

**WARNINGS:** This product is not a toy. Keep out of the reach of children.

• Watch its demo video on YouTube: [bit.ly/127-Video](https://bit.ly/127-Video)  
Or scan QR code

• Each SHARPAL product is warranted to be free from defects in material and workmanship for **3 years** from the date of purchase under normal wear and tear, except for damage caused by misuse or alteration. **THIS WARRANTY APPLIES ONLY TO NON-INDUSTRIAL OR NON-COMMERCIAL USE.** If you want to make a warranty claim, please contact us through SHARPAL website or send an email directly to [warranty@sharpal.com](mailto:warranty@sharpal.com).

