

SCISSORPAL ADJUSTABLE ANGLE SCISSORS SHARPENER

USER MANUAL



- 1 Main Support
- 2 Specialized Scissors Clamps
 - 2.1 Upper Clamps
 - 2.2 Lower Support Block
- 3 Angle Lock Knob
- 4 Support Bar
- 5 Sharpening Guide Rod
- 6 Angle Indicator with A & B Angle Scale
- 7 A & B Position Locking Knob
- 8 Hinge Joint
- 9 Specialized Diamond Abrasive Plate

ABRASIVE	GRIT LEVEL	USE
DIAMOND	COARSE 325 GRIT (45 MICRONS)	REPAIR
DIAMOND	FINE 600 GRIT (25 MICRONS)	SHARPEN

- 10 T-Handle Hex Wrench (Referred to "Wrench" in the Manual)
- 11 Scissors Tip Protective Cap
- 12 Marker

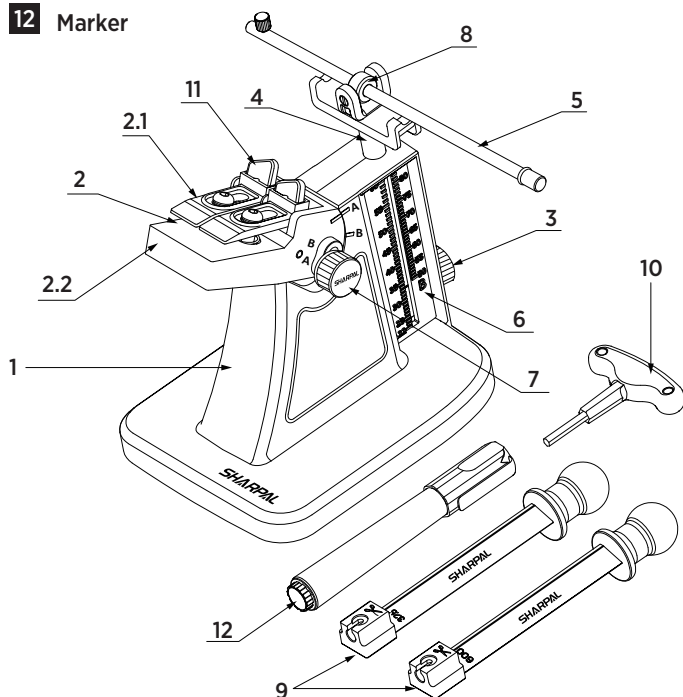

CAUTION:

1. To reduce the risk of injury, read and understand this user manual before using the product. Save the user manual for future reference.
2. Always wear safety goggles during operation.
3. To prevent scratches, we recommend applying masking tape (not included) on the scissor clamps.
4. Do not attempt to sharpen pinking shears, serrated scissors, nippers, or any blade that does not fit properly in the scissors clamps.
5. In case of measuring the sharpening angle with a digital angle gauge, add 25° for the A mounting position and 50° for the B mounting position to the displayed angle to get the true angle of the scissor blade.
6. Apply light pressure and let the abrasive do the work while sharpening. Excessive force may bend the sharpening guide rod.

GENERAL INSTRUCTION

1. For scissors with a steeply curved cutting edge, clamp the blade to ensure the entire cutting edge extends beyond the end of the lower support block. This ensures the entire edge can be sharpened.
2. For heavy-duty scissors (e.g., hedge shears, loppers, and grass shears), make sure the sharpener is securely fixed to the workbench such as using a C clamp before clamping the scissors. **DO NOT** clamp heavy-duty scissors until the sharpener is properly secured.
3. Maintain a sharpening log to record the edge angles for consistent results on the scissors.
4. Select the appropriate diamond plate: Use the Fine Diamond Plate for valuable or slightly dull scissors, and the Coarse Diamond Plate for dull or damaged edges that require a new edge.
5. When sharpening scissors, ensure the blade to be sharpened is securely clamped. Cover the other scissor tip with the protective cap to prevent potential injury (See Fig. 1).
6. Apply light pressure and let the abrasive do the work while sharpening. Excessive force may bend the sharpening guide rod.
7. If the scissors do not fit the scissors clamps, disassemble the scissors blades for sharpening. After sharpening, reassemble the scissors properly.

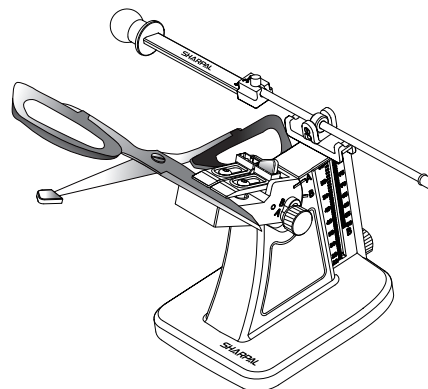

Fig. 1

ASSEMBLE THE SCISSORS SHARPENER

Loosen the screw and insert the sharpening guide rod through the hinge joint. Attach the sharpening guide rod to the abrasive plate and tighten the screw securely. (See Fig. 2)

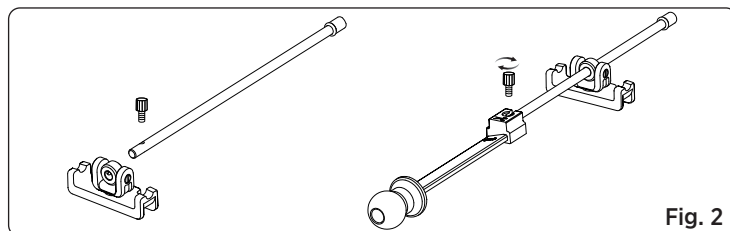

Fig. 2

Tip: Rest the sharpening guide rod on the parking slot of the support bar when clamping the scissors (See Fig. 3).

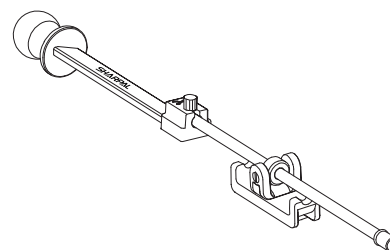

Fig. 3

SET THE SHARPENING ANGLE AND SCISSORS INSTALLATION

Note: The upper clamps can be adjustable to fit different scissor blade shapes. The two upper clamps do not need to be aligned with each other.

1. Select the Appropriate Angle

A mounting position: Refer to **A Angle Scale** for scissors with the sharpening angle range of 22°- 60°.

B mounting position: Refer to **B Angle Scale** for scissors with the sharpening angle range of 50°- 84°. (See Fig. 4)

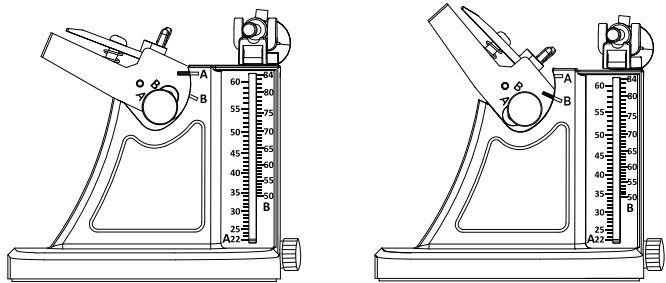

Fig. 4

2. Mounting Position

For scissors with a blade angle between 22° and 60°, set the scissor clamps to the **A** mounting position.

Tip: Align the indicator's white line with letter **A**, then tighten the position locking knob in the **A** mounting hole (See Fig. 5).

For scissors with a large blade angle (sharpening angle range from 50° to 84°), set the scissor clamps to the **B** mounting position.

Tip: Align the indicator's white line with letter **B**, then tighten securing the position locking knob in the **B** mounting hole (See Fig. 6).

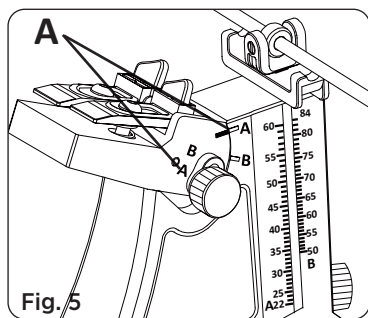

Fig. 5

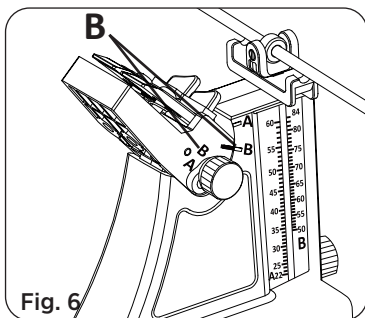

Fig. 6

3. Insert the scissor blade into the clamps and tighten it firmly. Make sure the cutting edge aligns with or slightly extends beyond the lower support block. Adjust the upper clamps to fit scissors with different blade widths (See Fig. 7).

4. Turn the angle lock knob to move the support bar up or down until the red line aligns with the desired angle on the scale (See Fig. 8). Then tighten the angle lock knob firmly.

A mounting position: Refer to the angle indicator on the **A** scale.

B mounting position: Refer to the angle indicator on the **B** scale.

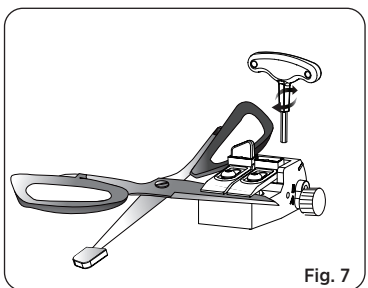

Fig. 7

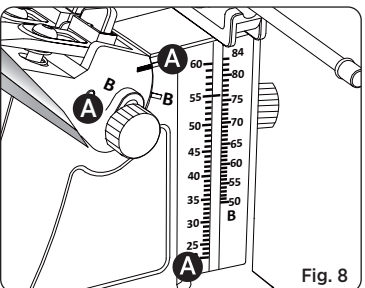

Fig. 8

Tip for Unknown Scissors Blade Angle

Apply a marker to the cutting edge. Adjust the support bar up or down as needed and gently sharpen the edge. When the marker is completely removed, revealing a clean edge

(See Fig. 9), the angle value on the scale (A or B) indicates the correct sharpening angle based on the mounting position of the scissors (A or B).

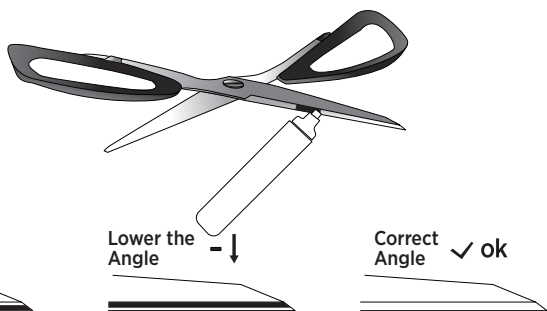

Fig. 9

SCISSORS SHARPENING

1. Select the appropriate abrasive plate based on sharpening needs.
2. Apply light pressure with long, smooth strokes, starting from the heel of the blade. Slide the abrasive plate back and forth along the cutting edge towards the tip. Stop at the tip of the blade (See Fig. 10).

Tip: Apply light pressure and let the abrasive do the work.

3. Switch to the other blade and sharpen it with the same number of strokes on this blade to ensure an even bevel.

Note: To sharpen the entire length of the cutting edge, open the scissors as wide as possible.

4. After sharpening the edges of scissors, there are rough burrs of metal across the sharpened edges of the blades. Burrs can quickly be removed by opening and closing them a few times.

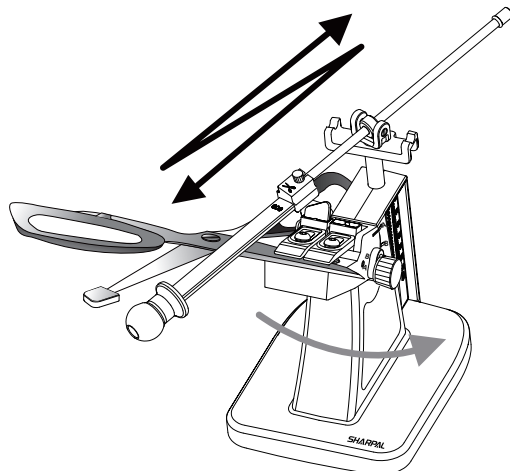

Fig. 10

MAINTENANCE

1. After sharpening, wipe the blade with a soft cloth or a folded paper towel to remove any residue.
2. Use a soft, dry cloth to wipe all parts of the sharpener and remove any metal shavings or debris.
3. Do not use oil or water while sharpening.
4. **NEVER** leave the scissors mounted in the sharpener when it's not in use.
5. After use, wipe all components clean and store the abrasive plates in a dry environment, avoid high temperature and damp conditions.
6. Abrasive plates can be replaced individually, visit sharpal.com for more information.

- Watch its demo video on YouTube: bit.ly/201video

Or scan QR code



- SHARPAL products are guaranteed against defects in materials and workmanship for **3 years** from the purchase date. This warranty excludes damage from misuse or alteration, normal wear and tear, and the natural diminishment of consumable items from regular use. Additionally, the warranty is valid only for non-industrial and non-commercial usage. If you want to make a warranty claim, please contact us through SHARPAL website or send an email directly to warranty@sharpal.com.